



**2025**  
**KENTUCKY**  
**FRUIT**  
**AND**  
**VEGETABLE**  
**CONFERENCE**

**LEXINGTON, KY**  
**JANUARY 6-7**





**2025**

# **Kentucky Fruit and Vegetable Conference**

**Kentucky State Horticultural Society  
169th Annual Meeting**

**Kentucky Vegetable Growers Association  
54nd Annual Meeting**

**Organic Association of Kentucky  
and  
Kentucky Horticulture Council**

In cooperation with

University of Kentucky Martin-Gatton College of Agriculture, Food and Environment

Kentucky State University College of Agriculture, Communities and the Environment

and

Kentucky Department of Agriculture

## **January 6-7, 2025**

**Pre-Conference Events January 5, 2025**

Marriott Griffin Gate  
Lexington, KY



# CONFERENCE AT-A-GLANCE

	<b>Sunday, January 5</b>	<b>Monday, January 6</b>		<b>Tuesday, January 7</b>	
	<b>Evening</b>	<b>Morning</b>	<b>Afternoon</b>	<b>Morning</b>	<b>Afternoon</b>
<b>Salon A &amp; B</b>	Tradeshow Set-up	Tradeshow & Coffee Break	Tradeshow & Coffee Break	Tradeshow & Coffee Break	Tradeshow
<b>Salon C</b>	Bringing the Farm to School Workshop	General Session	Direct Marketing	Organic Production	Marketing & Business Management
<b>Salon D</b>	Farmers Market Short Course		Fruit Physiology & Abiotic Stress — KY Strawberry Association Meeting	Fruit Pest & Disease Management — KSHS Business Meeting	Production Systems of Fruit Crops
<b>Salon E</b>	Farm Food Safety Plan Writing Workshop		Vegetable Production (Experienced)	KVGA Business Meeting — Vegetable Production (Beginner)	Urban & Small-Scale Farming
<b>Salon F</b>			Beginning Farmers	Specialty Cut Flower Short Course	Specialty Cut Flower Short Course
<b>Salon G &amp; H</b>		KSHS Board (G) KVGA Board (H)	Greenhouse Production	High Tunnel Production	Specialty Crop Block Grant Project Reports
<b>Lane's End, Dixiana, Darby Dan, and Calumet Rooms</b>	Tradeshow Set-up	Tradeshow & Coffee Break	Tradeshow & Coffee Break	Tradeshow & Coffee Break	Tradeshow

# CONFERENCE OVERVIEW

All Times are Eastern Standard Time

## Sunday, January 5 — Pre-Conference Sessions

3:00–9:00 p.m.	Registration	Front Foyer
3:00–9:00 p.m.	Exhibitor Set-up	Foyer, Salons A&B, Lane’s End, Dixiana, Darby Dan, and Calumet
4:00–6:00 p.m.	Bringing the Farm To School Grower Training	Salon C
4:00–6:00 p.m.	Farmers Market Short Course	Salon D
4:00–6:00 p.m.	Farm Food Safety Plan Writing Workshop	Salon E
6:00–8:00 p.m.	Grower-Buyer Meetings	Terrace
6:30–7:30 p.m.	Vegetable Growers Meet & Greet	Salon F
7:30–8:30 p.m.	Fruit Year in Review / Meet & Greet	Salon F

## Monday, January 6 — Conference Sessions

8:00 a.m.	Exhibits and Registration Desk Open
8:45 a.m.	General Session, Salons C-F
10:30 a.m.	Break
12:00 p.m.	Luncheon Salons A & B, C-F
1:30 p.m.	Concurrent Sessions Direct Marketing, Salon C Fruit Physiology & Abiotic Stress, Salon D Vegetable Production for Experienced Growers, Salon E Beginning Farmers, Salon F Greenhouse Production, Salons G & H
2:30 p.m.	Break
5:00 p.m.	Exhibits Close
5:20 p.m.	Kentucky Strawberry Association Meeting, Salon D
6:00 p.m.	Urban & Small Farms Meet & Greet: Building a Supportive Agricultural Community, Hotel Bar Area

## Tuesday, January 7 — Conference Sessions

8:00 a.m.	Exhibits and Registration Desk Open
8:30 a.m.	Concurrent Sessions Organic Production, Salon C Fruit Pest & Disease Management, Salon D Beginning Vegetable Production, Salon E Specialty Cut Flower Short Course, Salon F High Tunnel Production, Salons G & H
10:00 a.m.	Break
11:45 a.m.	Luncheon Salons A & B, C-F
1:30 p.m.	Concurrent Sessions Marketing & Business Management, Salon C Production Systems of Fruit Crops, Salon D Urban & Small-Scale Farming, Salon E Specialty Cut Flower Short Course, Salon F Specialty Crop Block Grant Project Reports, Salons G & H
3:00 p.m.	Exhibit Hall Closes
3:45 p.m.	A Deep Dive into Urban & Small- Scale Farming: Solutions-Based Roundtable
4:00 p.m.	Post-Conference Orchard Tour

# BOARDS OF DIRECTORS

## KY STATE HORTICULTURAL SOCIETY

President: Kevan Evans, Georgetown  
Vice-President: David Haney, Nancy  
Secretary: Joanna Hinton, Hodgenville  
Treasurer: Amanda Gajdzik, Shelbyville  
Directors:  
Brandon Barnett, Cynthiana  
Stuart Brenneman, Tipton, IN  
Kevin Byrnside, Shelbyville  
Megan Fields, Versailles  
Adam Jones, Morgantown  
Tommy Parker, Louisville  
Billy Reid, Owensboro  
Michelle Sigler, Paducah

### Advisors:

Brent Arnoldussen, Lexington  
Daniel Becker, Princeton  
Kirk Pomper, Frankfort  
Jonathan Price, Bowling Green  
Caroline Roush, Morehead  
John Strang, Lexington  
Shawn Wright, Jackson



## KY VEGETABLE GROWERS ASSOCIATION

President: Shubin Saha, Stanford  
Vice-President: Nathan Howell, Scottsville  
Secretary: Rhonda Cornett, London  
Treasurer: Ben Wilson, Richmond  
Directors:  
Andre Barbour, Canmer  
Jonathan Berkshire, Glencoe  
Travis Cleaver, Hodgenville  
Ron McMaine, Salvisa  
David Neville, Campbellsburg  
Brad Reid, Owensboro  
Catherine Shake, Louisville  
Megan Sharpe, Georgetown  
Kiristen Webb, Hazard  
Joel Wilson, Nancy

### Advisors:

Sandi Deutsch, Taylorsville  
Annette Meyer-Heisdorffer, Owensboro  
Rachel Rudolph, Lexington  
John Strang, Lexington  
Shawn Wright, Jackson



Are you interested in serving on the board of one of Kentucky's prestigious produce organizations?

You can indicate your interest at registration or contact the organization's current president with any questions:

### **Kentucky State Horticultural Society**

Kevan Evans (Kevan@evansorchard.com)

### **Kentucky Vegetable Growers Association**

Shubin Saha (s.saha@kyfreshharvest.com)

Why join the board of directors of KSHS or KVGA?

- Support your industry
- Expand your network
- Develop knowledge and skills to advance your business
- Influence policy decisions

Being a board member is an important responsibility and can have a tremendous positive impact on your personal business!

# BOARDS OF DIRECTORS

Chair:	Andrew Oles, Berea College, Madison County
Vice-Chair:	SaraVard Von Gruenigen, Central KY Ag Credit, Garrard County
Exec. Director:	Brooke Gentile, Fayette County
Secretary:	Bryce Baumann, Lazy Eight Stock Farm, Madison County
Treasurer:	Steve Muntz, Firefly Farm, Montgomery County
Directors:	Maggie Dungan, Salad Days Farm, Woodford County Carolyn Gahn, Applegate, Jessamine County Julia Sampson, Consultant, Washington County, AR Amber Sciligo, The Organic Center, Fayette County Tonya Smith, Kentucky Ag Development Advocacy, Barren County
Advisors:	Sean Clark, Berea College, Madison County David Gonthier, UK, Fayette County Krista Jacobsen, UK, Anderson County David Koester, UK, Boone County Rachel Rudolph, UK, Fayette County Mark Williams, UK, Fayette County



## 2025 Farmer Conference Sponsors



**BYRNSIDE  
ORCHARD**



# 2025 Conference Sponsors



**KENTUCKY STATE  
UNIVERSITY**



**GOWAN SEED  
COMPANY**





# PRE-CONFERENCE SESSIONS

SUNDAY, JANUARY 5

All Times Are Eastern Standard Time

4:00-6:00 p.m.

## **FARMERS MARKET SHORT COURSE**

Kate Hamilton and Sharon Spencer Presiding, Salon C

*Are you a farmers' market leader, farmers' market vendor or even just someone thinking about selling at a farmers' market? Join us for the pre-conference session for an engaging and interactive short course on farmers' markets. Come learn how to grow your market and grow your individual sales. Learn about new changes for 2025 for the farmers' market program, funding opportunities and updates from the farmers' market nutritional programs (Senior and WIC). But that's not all, from our partners with the University of Kentucky to learn about the farmers' market price reports from 2024 for rural vs. non-rural markets. Also, the UK team will be partnering up with CFA to discuss events, promotions and challenges facing markets. Lots of good information to take back to your markets.*

4:00-6:00 p.m.

## **FARM FOOD SAFETY PLAN WORKSHOP**

Bryan Brady and Courtney Bartlett, Presiding, Salon D

*Attention to food safety is critical to your farm's reputation. GAPs audits are becoming a standard requirement for many buyers of Kentucky produce crops and can give you a competitive advantage when selling. To help Kentucky growers focus on food safety and access markets that require third-party audit certification, we are offering a workshop focused on writing a farm food safety plan. The session will include an overview of different GAPs audits and details about on-farm technical assistance. You will learn the main structural components of a food safety plan such as standard operating procedures (SOPs), common food safety policies, and how to keep records efficiently. We will work through SOP and recordkeeping templates, and you will even get to write some specific to your operation with hands-on assistance. If you have a laptop, bring it along to work on the templates digitally. The format will be very interactive with opportunities to discuss challenges and develop solutions with experts.*

4:00-6:00 p.m.

## **BRINGING THE FARM TO SCHOOL GROWER TRAINING**

Laurie White, Presiding, Salon E

*Are you a KY producer interested in selling to school markets? We invite you to attend our Bringing the Farm to School Grower Training program. The Bringing the Farm to School curriculum is a series for ag producers from the National Farm to School Network meant to prepare producers to sell to school markets. With our KY spin, we hope you'll walk away feeling ready to approach your local school! All agriculture producers are invited to attend the training.*

6:00-8:00 p.m.

6:30-7:30 p.m.

## **VEGETABLE GROWERS YEAR IN REVIEW / MEET & GREET**

Rachel Rudolph, Presiding, Salon F

7:30-8:30 p.m.

## **FRUIT GROWERS YEAR IN REVIEW / MEET & GREET**

Brent Arnoldussen, Presiding, Salon F

5:00-9:00 p.m.

## **Exhibitor Set-up**

Foyer Area, Salons A&B, and Lane's End, Dixiana, Darby Dan, and Calumet Rooms

# GENERAL SESSION

MONDAY, JANUARY 6

All Times are Eastern Standard Time

## (1) General Session

Salons C, D, E, F

Kevan Evans, Presiding

- 9:00 a.m. 2025 Fruit & Vegetable Conference Welcome — Shubin Saha
- 9:10 a.m. Kentucky Horticulture Council Update — Trevor Terry
- 9:25 a.m. University of Kentucky Horticulture Department Update — Mark Williams
- 9:35 a.m. Kentucky State University Update — Marcus Bernard
- 9:45 a.m. Kentucky Department of Agriculture Produce Safety Update — Jonathan Shell
- 10:00 a.m. Kentucky Farm Bureau Farmland Transition Program — Renee Carrico
- 10:20 a.m. Building Bridges to Farmer Mental Health – Paul Norrod
- 10:40 a.m. Cider/Coffee Break and Visit Exhibits — Trade Show Areas
- 11:00 a.m. Weather Alert: NEW smartphone app from the UK Ag Weather Center – Matt Dixon
- 11:30 a.m. Produce Safety Grower Updates – Doris Hamilton and Paul Priyesh
- 12:00 p.m. EXHIBITOR/GROWER LUNCHEON — Salons A-F
- 12:00 p.m. KSHS and KVGA BOARD MEETINGS  
*KSHS and KVGA board members should pick up their lunch at the buffet in Salons A&B and then meet in the designated room.*  
Kentucky State Horticultural Society – Salon G  
Kentucky Vegetable Growers Association – Salon H

# MONDAY CONFERENCE SESSIONS

MONDAY AFTERNOON, JANUARY 6

4 CONCURRENT SESSIONS — All times are Eastern Standard Time

*Concurrent sessions enable participants to attend topics of interest in different sessions.*

## (2) DIRECT MARKETING

Salon C

Sharon Spencer, Presiding

- 1:30 p.m. *Deepening Customer Relationships Through Email Marketing* – Brett Wolff and Emily Spencer
- 2:00 p.m. *Succession Planning - Is it time to have “the talk”?* Kellie Padgett and Spencer Guinn
- 2:30 p.m. **Cider/Coffee Break and Visit Exhibits — Trade Show Areas**
- 3:10 p.m. *Mapping the Customer’s Journey: Marketing Strategies to Find & Keep Customers* – Emily Spencer
- 3:40 p.m. *Using Business Entities for Agriculture* – Rusty Rumley
- 4:10 p.m. *Landowner Liability and Agritourism Statutes in Kentucky* – Rusty Rumley
- 4:40 p.m. *Food Processing: From Home Based to Commercial*— Sally Dabb and Annhall Norris

## (3) FRUIT PHYSIOLOGY AND ABIOTIC STRESS

Salon D

Sarah Imbus, Presiding

- 1:30 p.m. *Developing Small-Scale Container Production of Native Fruiting Shrubs*—Marcus Wilkerson
- 2:00 p.m. *Branching Out: Overcoming Blind Wood and Increasing Lateral Bearing Surface in Apple Orchards* — Annie Vogel
- 2:30 p.m. **Cider/Coffee Break and Visit Exhibits — Trade Show Areas**
- 3:10 p.m. *Understanding and Managing Bitter-pit and other Calcium-related Disorders in Apple* — John Strang
- 3:40 p.m. *Impacts of Weather and Climate Trends on Fruit Production in Kentucky* — Matt Dixon
- 4:10 p.m. *Malusim: A Free Application for Precision Management of Apple* — Brent Arnoldussen
- 4:40 p.m. *Fruit Physiology and Abiotic Stress Grower Panel*

## (4) VEGETABLE PRODUCTION FOR EXPERIENCED GROWERS

Salon E

Robert Brockman, Presiding

- 1:30 p.m. *Maximizing Production Among the Rows* – Annette Wszelaki
- 2:00 p.m. *Getting the Most out of Your Winter Squash Crops: Which Types Yield and Store Best* – Annette Wszelaki
- 2:30 p.m. **Cider/Coffee Break and Visit Exhibits — Trade Show Areas**
- 3:10 p.m. *Pest Outlook for 2025* – Ric Bessin
- 3:40 p.m. *Southern Blight: The Hot Weather Foe* – Nicole Gauthier
- 4:10 p.m. *Biofumigation in Kentucky: Is It Feasible?* - Rachel Rudolph

## (5) BEGINNING FARMER BASICS

Salon F

Delia Scott, Presiding

- 1:30 p.m. *Essential Cover Crops for Beginning Farmers* – Steve Diver
- 2:00 p.m. *Producer Perspective* — Melissa Wyatt
- 2:30 p.m. **Cider/Coffee Break and Visit Exhibits — Trade Show Areas**
- 3:10 p.m. *What Can the UK CCD Do for You?* — Alexis Sheffield
- 3:40 p.m. *Equipment Basics for Beginning Farmers* – Steve Higgins
- 4:10 p.m. *Finding Your Market and Growing Your Sales: Marketing Strategies for Beginning Farmers* – Kati Bowman
- 4:40 p.m. *Resources for Beginning Farmers* – Angella Watson

# MONDAY CONFERENCE SESSIONS

MONDAY AFTERNOON AND EVENING, JANUARY 6

All Times are Eastern Standard Time

## (6) GREENHOUSE PRODUCTION

Salons G & H

Arundathi Sharma, Presiding

5:00 p.m. Exhibits Close

1:30 p.m. *Managing Greenhouse Diseases: Factors that Influence Fungicide Efficacy* — Nicole Gauthier

5:20 p.m. KY Strawberry Association Meeting

2:00 p.m. *Insuring Greenhouse Equipment* — Casey Byrd

2:30 p.m. **Cider/Coffee Break and Visit Exhibits — Trade Show Areas**

3:10 p.m. *Improving Lighting in Controlled Environments* — Qinglu Ying

3:40 p.m. Morehead State University Student Research Projects: *Developing a zeoponic lettuce production system in a controlled environment* — Hudson Cox and Ricky Young // *Establishing Blueberries in High-pH Soils: Concerns and Outcomes* — Kirsten Brown and Emma Miller

4:10 p.m. *Climate Management for Greenhouse Production* — Andrew Brooks

4:40 p.m. *On-farm Water Management in a Large-Scale Strawberry Greenhouse* — Bosch Berries

6:00-9:00 p.m. **Urban and Small-Scale Grower Meet and Greet:  
Building a Supportive Agricultural Community**

*Are you an urban or small-scale grower currently engaged in or interested in learning more about how to start or expand a produce or horticulture business in Kentucky? Join us for a Meet & Greet in the terrace bar area, open to all urban & small-scale growers and technical service providers.*



# TUESDAY CONFERENCE SESSIONS

TUESDAY MORNING, JANUARY 7 — All times are Eastern Standard Time

8:00 a.m. Exhibits Open & Registration Opens

## 5 CONCURRENT SESSIONS

*Concurrent sessions will enable participants to attend topics of interest in different sessions.*

### (7) ORGANIC PRODUCTION

Salon C

Sarah Guerink, Presiding

- 8:30 a.m. *Dialing in Fertility on High Tunnel Tomatoes for Quality and Yield* – Adam Barr and Rachel Rudolph
- 9:00 a.m. *Compost Use in Organic Vegetable Systems* – Krista Jacobsen
- 9:30 a.m. *Organic Weed Management Between Annual Vegetable Crop Beds* – Kristi Durbin and Erin Haramoto
- 10:00 a.m. **Cider/Coffee Break and Visit Exhibits — Trade Show Areas**
- 10:40 a.m. *Organic Lettuce Production Across All Seasons From Seed to Storage* – Bryce Baumann, Joseph Monroe, and Anna Raines
- 11:10 a.m. Continued

### (8) FRUIT PEST & DISEASE MANAGEMENT

Salon D

Jamie Dockery, Presiding

- 8:30 a.m. *Neopestalotiopsis in Strawberry: New Disease With New Challenges* — Nicole Gauthier
- 9:00 a.m. *Automated Pest Monitoring Systems for Orchards* — Ric Bessin
- 9:30 a.m. *Persistence of Woody Plant Diseases: Cankers Diebacks, and Blights* — Nicole Gauthier
- 10:00 a.m. **Cider/Coffee Break and Visit Exhibits — Trade Show Areas**
- 10:40 a.m. *Effects and Interactions of Annual Applications of Prohexadione Calcium and Actigard on Orchard Establishment, Yield, and Disease Management* — Annie Vogel
- 11:10 a.m. *Pest and Disease Grower Panel*

### (9) BEGINNING VEGETABLE PRODUCTION

Salon E

Kimberly Leonberger, Presiding

- 8:00 a.m. KVGA Annual Business Meeting
- 8:30 a.m. *Effects of Organic vs. Inorganic Fertilizers on Soil Health and Tomato Yield* – Myrrisa Belcher
- 8:45 a.m. *Impact of Compost on Soil and Plant Tissue Nutrition* – Eva Bogue, Anna Griggs, and Jonathan Barnes
- 9:00 a.m. *Movin' on Up! Grower Perspectives on Scaling Up Your Farming Operation* – Jonathan and Morgan Berkshire, Brent and Rhonda Cornett, Susan and George Miller
- 9:30 a.m. *Grower Perspectives, continued*
- 10:00 a.m. **Cider/Coffee Break and Visit Exhibits — Trade Show Areas**
- 10:40 a.m. *Tomato Blight - What Is It Anyway?* — Nicole Gauthier
- 11:10 a.m. *Herbicide Use 101* – Shawn Wright

Cider during conference breaks courtesy of:



# TUESDAY CONFERENCE SESSIONS

TUESDAY MORNING, JANUARY 7 — All times are Eastern Standard Time

## 5 CONCURRENT SESSIONS

*Concurrent sessions will enable participants to attend topics of interest in different sessions.*

### (10) CUT FLOWER SHORT COURSE

Salon F

Nikki Rhein, Presiding

### (11) HIGH TUNNEL PRODUCTION

Salons G & H

Kathryn Pettigrew, Presiding

- 8:30 a.m. *Knowing Your Production Costs* — Kelly Stanley
- 9:00 a.m. *Growing for Your Market: Color and Texture* — Alexis Sheffield
- 9:30 a.m. *IPM in the Cold: What Could Be Bugging You in the Winter?* — Jonathan Larson
- 10:00 a.m. **Cider/Coffee Break and Visit Exhibits — Trade Show Areas**
- 10:40 a.m. *Tulip Trauma and How to Avoid It* — Natalie Thodoropoulos
- 11:10 a.m. *Introduction to Weed Management for Cut Flower Producers* — Shawn Wright

- 8:30 a.m. *Crops Under Cover: Tips and Tricks for Using Row Cover* — Elaine Losekamp and Katie Fiske
- 9:00 a.m. *High Tunnel Maintenance: Start Now or Forever Hold Your Peace!* - Kayla Preston
- 9:30 a.m. *Soil Solarization for Managing Weeds, Pests, and Diseases* — Luize Lessmann and April Lamb
- 10:00 a.m. **Cider/Coffee Break and Visit Exhibits — Trade Show Areas**
- 10:40 a.m. *Grower Perspectives: Crop Rotation in High Tunnels* — Adam Barr, Dennis Family, and Maggie Dungan
- 11:10 a.m. *Grower Perspectives - Continued*

Short Course continued after lunch.

11:45 a.m. TUESDAY LUNCHEON — Salons A—F

Local sourcing of ingredients for lunches has been possible through Kentucky Proud Conference sponsorship



# TUESDAY CONFERENCE SESSIONS

TUESDAY AFTERNOON, JANUARY 7 — All times are Eastern Standard Time

## 5 CONCURRENT SESSIONS

*Concurrent sessions will enable participants to attend topics of interest in different sessions.*

### (12) MARKETING & BUSINESS MANAGEMENT

Salon C

Savannah Columbia, Presiding

- 1:30 p.m. *Farming the Digital Landscape: Building Your Brand Through Story* – Emily Spencer
- 2:00 p.m. *Building Resilient Partnerships with Retailers and Distributors* – Brandi Button-Johnson and Faye Kuosman
- 2:30 p.m. *Planning an On-Farm Event* – Ally Vallandingham
- 3:00 p.m. *Creating Your Business Roadmap: Key Steps for Developing a Comprehensive Business Plan* – Kati Bowman

### (13) PRODUCTION SYSTEMS OF FRUIT CROPS

Salon D

Delia Scott, Presiding

- 1:30 p.m. *Adapting Raised-bed Blueberry Systems to Kentucky* — John Strang
- 2:00 p.m. *Blackberry Production Systems* — Daniel Becker
- 2:30 p.m. *Update on Peach and Pear Systems Trials* — Brent Arnoldussen
- 3:00 p.m. *Production Systems Grower Panel*
- 3:30 p.m. KSHS Annual Business Meeting

#### ***Bonus Outdoor Training Sessions (North Farm)***

- 4:00 p.m. Intensive Training Systems for Peach Production
- 4:20 p.m. Tall Spindle Apple System for High Density Apples

### (14) URBAN AND SMALL-SCALE FARMING

Salon E

Michael Zachary, Presiding

- 1:30 p.m. *Cultivating Tomorrow: Harnessing Aquaponics for a Sustainable Future* – Trevor Claiborn
- 2:00 p.m. *Cultivating Tomorrow: FoodChain Student Research Projects* - Rianna Acton, Soren Burns, John Conley, Caris Francis, Sophia Lewis, Damien Powell, Javan White
- 2:30 p.m. *Maximizing Your Small-Scale Farm: Secrets to Successful Thriving* – Andre Barbour
- 3:00 p.m. *Farmers in Focus: An interview with Ryan Hodge and Rita Sims* – Ryan Hodge and Rita Sims

#### ***Bonus Grower Roundtable Discussion***

- 3:45 p.m. A Deep Dive into Urban & Small-Scale Farming: Solutions-Based Roundtable – Tonya Smith

### (16) CUT FLOWER SHORT COURSE

Salon F

Kristin Hildabrand, Presiding

- 1:30 p.m. *Grower Round Table – Let's Talk About Flowers* – Cindy Finneseth
- 2:00 p.m. *FSA-Noninsured Crop Disaster Program - Floriculture* – Maeci Moore
- 2:30 p.m. *Lessons in Building a Floral CSA & Subscription Program* – Mary Chauvin
- 3:10 p.m. *Elevating Your Seed Starting* – Tara Watkins Vaughn

# TUESDAY CONFERENCE SESSIONS

TUESDAY AFTERNOON, JANUARY 7 — All times are Eastern Standard Time

## 5 CONCURRENT SESSIONS

*Concurrent sessions will enable participants to attend topics of interest in different sessions.*

### (17) SPECIALTY CROP BLOCK GRANT PROJECT REPORTS

Salons G & H

Brett McQueary, Presiding

- 1:30 p.m. *New Digital Tools and Marketing Strategies for a Post-COVID-19 Marketplace* — Brett Wolff
- 1:45 p.m. *Evaluating the Inter-season Rotation of Tomato with Fresh-cut Flowers in a High Tunnel System for Improved Pest, Disease, and Soil Management* — Rachel Rudolph
- 2:00 p.m. *Increasing Consumer Demand for Kentucky Specialty Crops and Inspiring Beginning Farmers through Extension-Supported Gardening Programs* — Nicole Breazeale
- 2:15 p.m. *Kentucky Specialty Crop Block Grant Program: Tips and Keys for Success* —

**Bonus outdoor event: training systems and pruning demo at the new UK modern training systems orchard at the UK North Farm off Newtown Pike**

*(Note: transportation not provided and dress for the weather)*

#### **4:00 pm Intensive Training Systems for Peach Production**

Learn about the new high-density training systems for peach, including v trellis systems, planar systems, and free-standing systems including pruning demos on the pruning principles.

#### **4:20 pm Tall Spindle Apple System for High Density Apples**

Hands on pruning demo looking at the different pruning approaches and principles for tall spindle apples.

#### **Bonus Grower Roundtable** Roundtable Topics:

**Bridging the Gap: How Small Farmers Can Gain Visibility in a Big Ag World** - exploring strategies for small and urban farmers to get noticed by government agencies, larger markets, and consumers, ensuring their voices are heard in spaces often dominated by big agriculture.

**Navigating Agency Interactions: Building Strong Relationships with USDA, NRCS, and FSA** - a practical discussion on how to effectively engage with government agencies, understand their processes, and ensure you're accessing the right resources. This includes tips on making your case and advocating for yourself as a small-scale farmer.

**Protecting Your Farm: Avoiding Scams and Exploitation by For-Profit Agencies** - recognizing warning signs of fraudulent offers and services targeted at small farmers, providing tips on how to verify the legitimacy of funding opportunities, resources, or partnerships. Also, exploring ethical alternatives to for-profit agencies.

**Leveraging Resources: How Small Farmers Can Access Support Beyond Big Agriculture** - non-traditional funding and support networks for small-scale and urban farmers, including community grants, cooperative funding, and alternative financial tools to help farmers access capital without relying on big agriculture.

**Advocacy in Action: Raising Awareness and Fighting for Representation as a Small-Scale Farmer** - focusing on how small farmers can organize and advocate for policy changes, gain representation in agricultural boards, and participate in local and state-level discussions to ensure their unique needs are met.



# CONFERENCE SPEAKERS

Rianna Acton, Student, FoodChain, Lexington, KY

Dr. Brent Arnoldussen, Extension Fruit Specialist, Department of Horticulture, University of KY, Lexington, KY

Andre Barbour, Grower, Barbour's Farm, Canmer, KY

Dr. Marcus Bernard, Dean of the College of Agriculture, Health, and Natural Resources and Director of Land Grant Programs, Kentucky State University, Frankfort, KY

Jonathan Barnes, Student, Murray State University, Murray, KY

Adam Barr, Grower, Barr Farms, Rhodelia, KY

Courtney Bartlett, Extension Associate, Cultivate Kentucky, University of KY, Lexington, KY

Bryce Baumann, Grower, Lazy Eight Stock Farm, Paint Lick, KY

Daniel Becker, Small Fruit and Vegetable Extension Associate, University of Kentucky Research and Education Center, Princeton, KY

Myrrisa Belcher, Student, Western KY University, Bowling Green, KY

Jonathan and Morgan Berkshire, Growers, Berkshire Farms, Glencoe, KY

Dr. Ric Bessin, Extension Entomologist, Dept. of Entomology, University of KY, Lexington, KY

Eva Bogue, Student, Murray State University, Murray, KY

Kati Bowman, Marketing and Business Development Specialist, Kentucky Center for Agriculture and Rural Development, Elizabethtown, KY

Bryan Brady, Extension Associate Sr, Cultivate Kentucky, University of KY, Lexington, KY

Dr. Nicole Breazeale, Assoc. Professor, Community Leadership Development, University of KY, Lexington, KY

Robert Brockman, Boone County Extension Agent for Horticulture, Burlington, KY

Andrew Brooks, Business Development Manager: Southeastern US, Priva

Kirsten Brown, Student, Morehead State University, Morehead, KY

Soren Burns, Student, FoodChain, Lexington, KY

Brandi Button-Johnson, Western KY Value Chain Coordinator, The Food Connection, University of Kentucky, Lexington, KY

Casey Byrd, Extension Associate, Department of Horticulture, University of Kentucky, Lexington, KY

Renee Carrico, Director, Commodity Division, KY Farm Bureau, Louisville, KY

Mary Chauvin, Grower, Calamity Blooms, Oldham County, KY

Trevor Claiborn, Aquaponics Educator, FoodChain, Lexington, KY

Savannah Columbia, Extension Associate, University of KY Dept. of Ag Economics, Lexington, KY

John Conley, Student, FoodChain, Lexington, KY

Brent and Rhonda Cornett, Growers, Cornett Enterprises, London, KY

Hudson Cox, Student, Morehead State University, Morehead, KY

Sally Dabb, Food Manufacturing Supervisor, KY Department for Public Health, Frankfort, KY

Donald and Lesley Dennis, Solway Farm, Eastview, KY

Steve Diver, Farm Superintendent, University of Kentucky Horticulture Research Farm, Lexington, KY

Matt Dixon, Senior Meteorologist, UK Ag Weather Center, University of KY, Lexington, KY

Jamie Dockery, Fayette Co Extension Agent for Horticulture, Lexington, KY

Maggie Dungan, Grower, Salad Days Farm, Versailles, KY

Kristi Durbin, Farm Manager, University of KY Horticulture Research Farm – Community Supported Agriculture (CSA) Unit, Lexington, KY

Tiffany Bellfield El-Amin, Executive Director, KY Black Farmers Association, Madison County, KY

Kevan Evans, President, KY State Horticultural Society (KSHS) and Grower, Evans Orchard and Cider Mill, Georgetown, KY

Dr. Cindy Finneseth, Extension Specialist, Department of Horticulture, University of KY, Lexington, KY

Dr. Katie Fiske, Post-Doctoral Research Associate, Department of Entomology, University of Kentucky, Lexington, KY

Caris Francis, Student, FoodChain, Lexington, KY

Dr. Nicole Gauthier, Extension Plant Pathologist, Department of Plant Pathology, University of Kentucky, Lexington, KY

Anna Claire Griggs, Student, Murray State University, Murray, KY

Sarah Guerink, Organic Production Specialist, Organic Association of Kentucky, Lexington, KY

Spencer Guinn, Business Specialist, Kentucky Center for Agriculture and Rural Development (KCARD), Elizabethtown, KY

Doris Hamilton, Plant Division Director, Kentucky Department of Agriculture, Frankfort, KY

Kate Hamilton, Farmers Markets, KY Department of Ag, Frankfort, KY

Dr. Erin Haramoto, Associate Professor, Department of Plant and Soil Sciences, University of KY, Lexington, KY

# CONFERENCE SPEAKERS

Dr. Steve Higgins, Assistant Adjunct Professor, Director of Environmental Compliance, Dept. of Biosystems and Agricultural Engineering, University of Kentucky, Lexington, KY

Kristin Hildabrand, Warren County Extension Agent for Horticulture, Bowling Green KY

Ryan Hodge, Grower, Hodge Family Farm, Hodgenville, KY

Sarah Imbus, Horticulture Agent, Campbell Co Cooperative Extension Service, Highland Heights, KY

Kelly Jackson, Horticulture Agent, Christian Co Cooperative Extension Service, Hopkinsville, KY

Krista Jacobsen, Associate Professor, Department of Horticulture, University of KY, Lexington, KY

Faye Kuosman, Central KY Value Chain Coordinator, The Food Connection, University of Kentucky, Lexington, KY

Dr. April Lamb, Post-Doctoral Research Associate, Department of Plant Pathology, University of KY, Lexington, KY

Dr. Jonathan Larson, Extension Entomologist, Department of Entomology, University of Kentucky, Lexington, KY

Kimberly Leonberger, Extension Associate, Department of Plant Pathology, University of Kentucky, Lexington, KY

Luize Lessmann, Graduate Research Assistant, Department of Horticulture, University of KY, Lexington, KY

Sophia Lewis, Student, FoodChain, Lexington, KY

Elaine Losekamp, Graduate Research Assistant, Department of Entomology, University of KY, Lexington, KY

Ryan Mairs, Produce Safety, KY Dept. of Agriculture, Frankfort, KY

Brett McQueary, Program Coordinator Specialty Crop Block Grants, Office of Agriculture Marketing, KY Dept. of Agriculture, Frankfort, KY

Emma Miller, Student, Morehead State University, Morehead, KY

Susan and George Miller, Growers, Miller Farms, Stanford, KY

Joseph Monroe, Grower, Valley Spirit Farm, Campbellsburg, KY

Maeci Moore, USDA- FSA NAP Specialist, USDA Farm Service Agency, Lexington, KY

Annhall Norris, Food Preservation Extension Specialist, University of Kentucky, Lexington, KY

Dr. Paul Norrod, Assistant Professor, University of Cincinnati College of Nursing, Cincinnati, OH

Kellie Padgett, Senior Business Development Specialist, Kentucky Center for Ag and Rural Development, Elizabethtown, KY

Kathryn Pettigrew, Research Analyst, Department of Horticulture, University of KY, Lexington, KY

Damien Powell, Student, FoodChain, Lexington, KY

Kayla Preston, Social Enterprise Manager, Grow Appalachia, Berea, KY

Dr. Paul Priyesh, Food Science/Safety Specialist, Animal and Food Sciences Food Science Innovation Center, University of KY, Lexington, KY

Anna Raines, Grower, Rains and Sun Hilltop Farm, Independence, KY

Nikki Rhein, Marshall County Extension Agent for Agriculture and Natural Resources, Benton, KY

Dr. Rachel Rudolph, Assistant Professor and Extension Vegetable Specialist, Department of Horticulture, University of KY, Lexington, KY

Rusty Rumley, Senior Staff Attorney, National Ag Law Center, Fayetteville, AR

Dr. Shubin Saha, President, Kentucky Vegetable Growers Association, and Chief Operating Officer, Kentucky Fresh Harvest, Stanford, KY

Delia Scott, Extension Associate, Department of Horticulture, University of Kentucky, Lexington, KY

Arundathi Sharma, Extension Associate, Department of Horticulture, University of KY, Lexington, KY

Alexis Sheffield, Extension Specialist, Center for Crop Diversification, Dept. of Horticulture, University of KY, Lexington, KY

Jonathan Shell, Commissioner, Kentucky Department of Agriculture, Frankfort, KY

Rita Sims, Grower and Community Director, Kentucky Ag Development Advocacy, Hopkinsville, KY

Tonya Smith, Generational Farmer and Founder, Kentucky Ag Development Advocacy, Park City, KY

Emily Spencer, Extension Associate, Department of Ag Economics, University of KY, Lexington, KY

Sharon Spencer, Division Director, Direct Farm Marketing, Kentucky Department of Ag, Frankfort, KY

Kelly Stanley, Grower, Gray Arbor Farm, Georgetown, KY

Dr. John Strang, Emeritus Extension Fruit and Vegetable Specialist, Department of Horticulture, University of Kentucky, Lexington, KY

Trevor Terry, Executive Director, KY Horticulture Council, Lexington, KY

Natalie Thodoropoulos, Grower, Tulip Lane Flower Farm, Paducah, KY

Ally Vallandingham, Grower, Stepping Stone Farm, Paris, KY

Tara Watkins Vaughn, Nursery Crops Extension Associate, Department of Horticulture, University of Kentucky, Lexington, KY

Annie Vogel, Tree Fruit Extension Specialist, University of Tennessee, Knoxville, TN

# CONFERENCE SPEAKERS

Angella Watson, Program Specialist, Beginning Farmer Coordinator, FOIA/Privacy Act Coordinator; Climate-Smart Grant POC, USDA Farm Service Agency, Lexington, KY

Javan White, Student, FoodChain, Lexington, KY

Laurie White, Central Kentucky Local Food Coordinator, Community Farm Alliance, Berea, KY

Marcus Wilkerson, Student, KY State University, Frankfort, KY

Dr. Mark Williams, Chair, Dept of Horticulture, University of KY, Lexington, KY

Brett Wolff, Extension Associate, Department of Ag Economics, University of KY, Lexington, KY

Dr. Shawn Wright, Extension Horticulture Specialist, Department of Horticulture, University of KY, Robinson Center for Appalachian Resource Sustainability, Jackson, KY

Dr. Annette Wszelaki, Professor and Vegetable Extension Specialist, University of Tennessee, Knoxville, TN

Melissa Wyatt, Owner/Operator, Wyatt's Chapel Farm, London, KY

Dr. Qinglu Ying, Controlled Environment Production Extension Specialist, Department of Horticulture, University of KY, Lexington, KY

Ricky Young, Student, Morehead State University, Morehead, KY

Michael Zachary, State Outreach Coordinator, USDA – Natural Resources Conservation Service, Lexington, KY

# TRADE SHOW EXHIBITORS

Aero Ag, LLC  
324 S Lincoln Blvd.  
Hodgenville, KY 42748  
270-401-6877  
calebcanter22@gmail.com  
www.aeroag.us/

Agrauxine by Lesaffre  
316 Key West Dr  
Evansville, IN 47712 US  
414-340-1648  
j.klostermann@agrauxine.lesaffre.com  
https://agrauxine.com/us/

Bluegrass Ag Workers Services  
1890 Starshoot Pkwy Ste 170-110  
Lexington, KY 40509  
859-279-2057  
buffy@bluegrassagworkers.com  
www.bluegrassagworkers.com/

Bluegrass Blueberries  
11067 Porter Pike Rd.  
Oakland, KY 42159  
270-432-5836  
blueberrynurseryky@gmail.com  
www.bluegrassblueberries.com

CaluSolv, LLC  
PO Box 130  
Franklin, KY 42135  
833-349-7645  
stan@calusolv.com  
https://calusolv.com/

Central Kentucky AgCredit  
2429 Members Way  
Lexington, KY 40544-4100  
859-252-4717  
888-820-3270  
www.agcreditonline.com/

Clifton Seed Company  
P.O. Box 206  
Faison, NC 28341  
910-267-2690  
brandim@cliftonseed.com  
www.cliftonseed.com

Community Farm Alliance  
327 Chestnut St. Suite 1  
Berea, KY 40403  
859-756-6378  
info@cfaky.org  
https://cfaky.org/

Continental Industries  
P.O. Box 865  
Shepherdsville, KY 40165  
502-543-2600  
jchamilton@windstream.net

Cushman Creek Supply  
1205 C.R. 24  
Marengo, OH 43334

Deerfield Supplies  
8208 W. Jefferson Davis HWY  
Elkton, KY 42220

Fairview Produce Auction  
10292 US Hwy 68E  
Pembroke, KY 42266  
270-887-0053

Ferris Farm  
83 Ferris Rd  
New Wilmington, PA 16142  
724-971-0888  
www.ferrisfarm.net/

Farm Credit Mid-America  
12501 Lakefront Place  
Louisville, KY 40299  
https://www.fcma.com/home

Feeding Kentucky  
106 Progress Dr  
Frankfort, KY 40601  
502-699-2656  
sarah@feedingky.org  
https://feedingky.org/

Fresh Start Growers' Supply  
1007 E. Jefferson St  
Louisville, KY 40206  
502-442-7883  
steveparadis@gmail.com  
www.freshstartgrowers.com/

Glacier Valley Enterprises  
600 South Blvd.  
Baraboo, WI 53913  
608-356-2244  
www.glacierv.com

# TRADE SHOW EXHIBITORS

Gowan Seed Co  
25445 Chualar River Rd.  
Chualar, CA 93925  
831-679-1900  
831-744-9069  
info@gowanseed.com  
Tsimpson@gowanseed.com  
<https://www.gowanseed.com>

Grow Appalachia  
210 Center St.  
Berea, KY 40403  
info@growappalachia.org  
<https://growappalachia.berea.edu/>

Hart County Produce Auction  
6880 Cub Run Hwy  
Munfordville, KY 42765  
270-925-9437

Kentucky Cabinet for Economic  
Development  
Old Capitol Annex  
300 West Broadway  
Frankfort, KY 40601  
502-564-7670  
800-626-2930  
[www.ced.ky.gov](http://www.ced.ky.gov)

Kentucky Center for Agriculture and  
Rural Development  
411 Ring Rd  
Elizabethtown, KY 42701  
502-536-3391  
lkurtz@kcard.info  
<https://www.kcard.info/>

Kentucky Proud  
Kentucky Department of Agriculture  
Office of Marketing  
111 Corporate Drive  
Frankfort, KY 40601  
502-782-4115  
[www.kyagr.com/marketing](http://www.kyagr.com/marketing)

Kentucky Department of Agriculture  
Produce Safety  
107 Corporate Drive  
Frankfort, KY 40601  
502-782-4115  
[www.kyagr.com/marketing/produce-safety.html](http://www.kyagr.com/marketing/produce-safety.html)

Kentucky Farm Bureau  
Certified Farm Market Program  
P.O. Box 20700  
Louisville, KY 40250  
502-495-5000  
fran.mccall@kyfb.com  
[www.kyfb.com/federation/programs/certified-farm-markets/](http://www.kyfb.com/federation/programs/certified-farm-markets/)

Kentucky Fertilizer  
303 Hill St  
Winchester, KY 40391  
859-744-3759  
mpickett@kyfertilizer.com  
<https://kyfertilizer.com/>

Kentucky Department for Public  
Health—Cabinet for Health and Family  
Services  
275 E. Main St.  
Frankfort, KY 40621  
502-564-3970  
<https://www.chfs.ky.gov>

Kentucky Horticulture Council  
PO Box 21736  
Lexington, KY 40522  
859-490-0889  
info@kyhortcouncil.org  
[www.kyhortcouncil.org](http://www.kyhortcouncil.org)

Kentucky Office of Adult Education,  
Reentry and Employment Services  
Branch  
2355 Nashville Rd  
Bowling Green, KY 42101  
<https://kyae.ky.gov/find-your-services/Pages/Second-Chance.aspx>

Kentucky Office of Agricultural Policy  
107 Corporate Dr.  
Frankfort, KY 40601  
502-573-0282  
koap@ky.gov  
[www.kyagr.com/agpolicy](http://www.kyagr.com/agpolicy)

Kentucky State University  
129 Atwood Research Facility, Frank-  
fort, KY 40601  
502-597-5942  
Joni.nelson@kysu.edu  
[www.kysu.edu](http://www.kysu.edu)

Kentucky Women in Agriculture  
P.O. Box 4409  
Lexington, KY 40544-4409  
(606) 307-7723  
kentuckywomeninag@gmail.com  
[www.kywomeninag.com](http://www.kywomeninag.com)

Koppert  
1502 Old US 23  
Howell, MI 48843  
800-928-8827  
info@koppertonline.com  
<https://www.koppertus.com/>

Lemongrass Spa  
Leitchfield, KY  
pamelasshop@comcast.net  
<https://www.facebook.com/PamelasLGShop/>

Lewis Seed Co  
130 N Spring St  
Louisville, KY 40206  
502-587-1241  
lewissseedcompany@gmail.com  
<https://lewissseedcompany.com/>

Lincoln County Produce Auction  
2896 KY Hwy 39N  
Crab Orchard, KY 40419  
606-355-0030

Martin's Produce Supplies  
2518 S Fork Creek Rd  
Liberty, KY 42539  
606-787-9389

Midwest Vineyard Supply  
2300 South Twin Bridge Road  
Decatur, IL 62521  
217-864-9896  
sales@midwestvineyardsupply.com

National Center for Appropriate  
Technology  
3040 Continental Drive  
PO Box 3838  
Butte, MT 59702  
800-275-6228  
tammyb@ncat.org  
[www.attra.ncat.org](http://www.attra.ncat.org)

Nutrien Ag Solutions  
7855 W 650 S  
Rossville, IN 46065  
765-714-8387  
stuart.brenneman@nutrien.com

Ohio Earth Food  
5488 Swamp St NE  
Hartsville, OH 44632  
330-877-9356  
info@ohioearthfood.com  
<https://ohioearthfood.com/>

Organic Association of Kentucky  
PO Box 22244  
Lexington, KY 40522  
502-218-7378  
info@oak-ky.org



# TRADE SHOW EXHIBITORS

Organic Valley -  
CROPP Cooperative  
1 Organic Way  
La Farge, WI 54639  
888-809-9297  
holly.mahan@organicvalley.coop  
www.farmers.coop

OrganiLock  
4100 Nebo Rd  
Madisonville, KY 42431  
(270) 326-2006  
sales@organilock.com  
www.organilock.com

Raising Hope  
www.raisinghopeky.com

Rockford Package Supply  
1080 Vitality Dr. NW  
Comstock Park, MI 49321  
800-444-7225  
marys@rockfordpack.com  
https://rockfordpack.com

Rovensan Next  
info@rovensanext.com  
https://www.rovensanext.com/en/

Rupp Seeds  
17919 Co Rd B  
Wauseon, OH 43567  
419-337-7093  
ryani@ruppseeds.com  
www.ruppseeds.com

Schrock Sales  
2598 HWY 39N  
Crab Orchard, KY 40419

Seedway, LLC  
PO Box 250  
Hall, NY 14463  
585-526-6394  
865-548-7333  
khosey@seedway.com  
mrobson@seedway.com  
www.seedway.com

Shelby Insurance Agency  
500 Main St., Ste 8  
Shelbyville, KY 40065  
502-633-6108  
SIA@iglou.com  
www.shelbyinsuranceagency.com

Southeast Center for Agricultural  
Health and Injury Prevention  
1398 Nicholasville Rd  
Lexington, KY 40546  
859-533-3782  
ashley.rockwell@uky.edu  
https://www.uky.edu/scahip/

Southern Container Corp of Wilson, Inc  
PO Box 216  
Wilson, NC 27894  
252-230-1376  
cthompson@socontainers.com  
https://socontainers.com/

Sun Sugar Farms  
1258 Maddox Lane  
Verona, KY 41092  
888-883-7259  
859-630-2694  
linda@sunsugarfarms.com  
https://sunsugarfarms.com/

Timac Agro USA  
153 Angstadt Lane  
PO BOX 888  
Reading, PA 19607  
800-545-5474  
contact@timacusa.com  
john.hopson@timacusa.com  
https://us.timacagro.com/

Center for Crop Diversification  
University of Kentucky  
N-318 Ag. Science Center North  
Lexington, KY 40546-0091  
859-257-5635  
alexis.sheffield@uky.edu  
brett.wolff@uky.edu  
www.uky.edu/ccd

Food Connection  
University of Kentucky  
440 Hilltop Avenue  
Lexington, KY 40506  
859-218-4987  
foodconnection@uky.edu  
www.foodconnection.ca.uky.edu

Office of the State Entomologist  
University of Kentucky  
S-225 Ag. Sci. Ctr. N  
Lexington, KY 40546-0091  
859-257-5838  
Jtcollin@uky.edu  
ky-ose@lsv.uky.edu  
https://ose.uky.edu/

United States Department of  
Agriculture Farm Service Agency Out-  
reach and Communications  
771 Corporate Drive  
Lexington, KY 40503  
phone: 859-224-7624  
jeremy.stevenson@usda.gov

United States Department of  
Agriculture Natural Resources  
Conservation Service  
(USDA-NRCS)  
771 Corporate Dr. Ste 300  
Lexington, KY 40503  
859-224-7314  
michael.zachary@usda.gov

United States Department of  
Agriculture National Agricultural  
Statistics Service  
(USDA NASS)  
Eastern Mountain Region  
601 W. Broadway St Ste 645  
Louisville, KY 40202  
502-907-3210  
david.knopf@usda.gov

United States Department of  
Agriculture Risk Management  
Agency  
(USDA RMA)  
803 Liberty Road  
Jackson, MS 39232  
601-965-4771  
Cody.Adkins@rma.usda.gov  
www.rma.usda.gov

VanMeter Family Farm  
164 Old Peonia Loop  
Clarkson, KY 42726  
270-963-2320  
vanmeterfamilyfarm@gmail.com

Warner Packaging  
4020 Corporate Ave.  
Plover, WI 54467  
715-341-8563  
715-340-8140  
Rob.caldwell@warnerpackaging.  
com  
www.warnerpackaging.com

## Literature Exhibitors:

Nourse Farms  
41 River Rd  
South Deerfield, MA 01093  
877-632-3779  
info@noursefarms.com  
https://www.noursefarms.com/

Seven Springs Farm Supply  
426 Jerry Ln NE  
Check, VA 24072  
540-651-3228  
800-540-9181  
7springs@swva.net

# HOTEL MAP

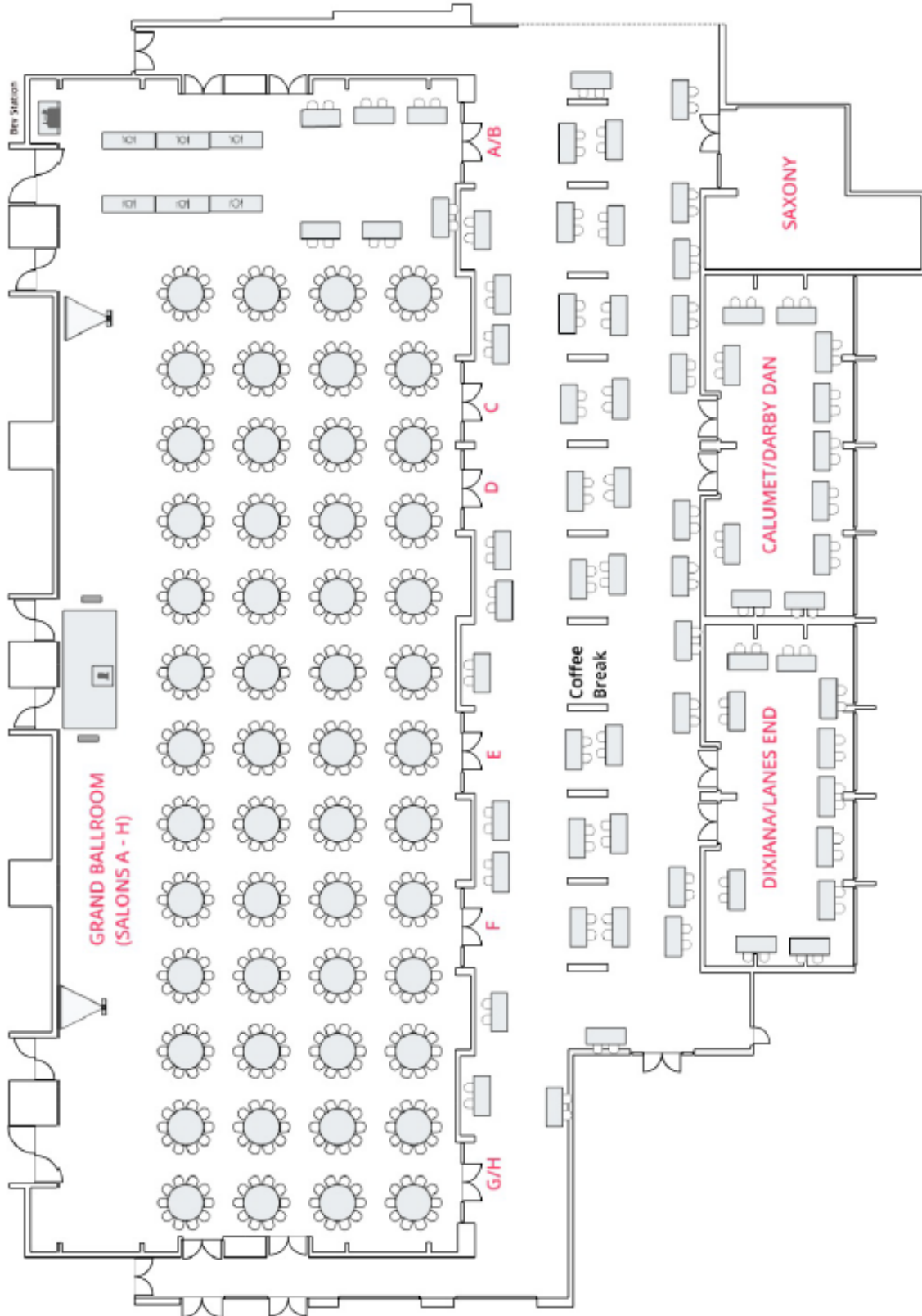



Kentucky Vegetable Growers Association

Kentucky State Horticulture Society

PO Box 21736

Lexington, KY 40522-1736

Please scan the qr code below with your phone to provide feedback and help us improve future events:



Please scan the qr code below with your phone and give suggestions for topics/speakers at the 2026 Fruit & Vegetable Conference:

